

DOCUMENT 00 90 00
ADDENDUM

ADDENDUM NO. [1] **Date: September 21, 2017**

RE: **WESTERN TECHNICAL COLLEGE – SPARTA CAMPUS**
SPARTA PUBLIC SAFETY WELL PROJECT
11177 COUNTY HWY “A”
SPARTA, WISCONSIN 54656
HSR PROJECT NO. 17049-3

FROM: HSR Associates, Inc
100 Milwaukee Street
La Crosse, WI 54603
(608) 784-1830

To: Prospective Bidders

This addendum forms a part of the Contract Documents and modifies the original Bidding Documents dated August 2017. Acknowledge receipt of this Addendum in the space provided on the bid form. Failure to do so may subject the Bidder to disqualification.

This Addendum consists of [1] page, and [1] 24 x 36 drawing.

CHANGES TO BIDDING REQUIREMENTS, CONTRACT FORMS, AND CONDITIONS OF THE CONTRACT:

1. Section 00 41 00 BID FORM
 - a. Revised Bid Form attached hereto.

CHANGES TO SPECIFICATIONS:

2. Section 01 10 00 SUMMARY OF THE WORK Page 1.
 - a. Revised section attached hereto with added text in red and eliminated text crossed out. Note that the new well will not have future potable use features.

CHANGES TO DRAWINGS

3. Sheet C100 24 x 36 attached hereto.
 - a. Drawing attached as reference only, showing revised well location and artesian spill pipe.

END OF DOCUMENT 00 90 00

Page Intentionally Left Blank

DOCUMENT 00 41 00

BID FORM (Revised)

BIDDER:_____

BID FOR SINGLE PRIME CONTRACT

PROJECT: **WESTERN TECHNICAL COLLEGE – SPARTA CAMPUS
SPARTA PUBLIC SAFETY WELL PROJECT
11177 COUNTY HWY “A”
SPARTA, WISCONSIN 54656
HSR PROJECT NO. 17049-3**

TO: **WESTERN TECHNICAL COLLEGE
400 SEVENTH STREET NORTH
LA CROSSE, WISCONSIN 54601
ATT: JAY McHENRY**

BASE BID

The undersigned, having examined the site where the Work is to be executed and become familiar with local conditions affecting the cost of the Work and carefully examined the Project Manual, the Project Drawings, all other Bidding Documents and Addenda thereto prepared by the AE, HSR Associates, Inc., hereby agrees to provide all labor, materials, equipment and services necessary for the complete and satisfactory execution of the ENTIRE WORK, for the Base Bid stipulated sum of:

_____ Dollars (\$_____.00)

ALTERNATE BIDS

The undersigned further agrees to perform the alternative portions of the Work as described, for the following additions to or deductions from the Base Bid sum stipulated above:

Alternate No. 1: Artesian Well Accessories

The following work shall be priced under Alternate No. 1: State the amount to be deducted from the base bid to delete the spill pipe in Paragraph c. and the Work of Paragraph i. in the revised Scope of Work attached to Addendum 1.

Deduct _____ Dollars (\$_____.00)

In submitting this Bid, the undersigned agrees to:

1. Hold this Bid open for **60** days.
2. Accept the provisions of Instructions to Bidders regarding disposition of Bid Security.
3. Enter into and execute an Agreement, if awarded on the basis of this Bid, and to furnish Performance and Labor and Material Payment Bonds according to the Supplementary Conditions.
4. Accomplish work according to the Contract Documents.
5. Complete the work by the time stated in Section 01 10 00 Summary of the Work.

Page Intentionally Left Blank

Receipt of the following Addenda and inclusion of their provisions in this Bid is hereby acknowledged:

Addendum No. _____ Dated _____

Addendum No. _____ Dated _____

Addendum No. _____ Dated _____

Addendum No. _____ Dated _____

Attached hereto are the required:

- a. () Bid Security
- b. () Certificate of Organization and Authority
- c. () Non-Collusive Affidavit: An affidavit in proof that the undersigned has not entered into any collusion with any person in respect to this Bid or any other bid or the submitting of bids for the contract for which this bid is submitted.
- d. () Certification of Non-segregated Facilities

FIRM NAME: _____

(Affix seal if
Corporation)

By: _____

Title: _____

By: _____

Title: _____

Date: _____

Official Address: _____

Telephone: _____

END OF DOCUMENT 00 41 00

Page Intentionally Left Blank

SECTION 01 10 00

SUMMARY OF THE WORK

PART 1: GENERAL

1.01 PROJECT LOCATION

- A. The Project Site is located as noted on Title Page.

1.02 DESCRIPTION OF THE WORK **Items in red indicate change from original document.**

- A. Work includes, but is not limited to drilling a new 10", 300 ft. deep non-potable well, for fire protection only, and pump system to a new fire hydrant.
- a. Locate well and fire hydrant with Owner.
 - b. Obtain state well permit as required.
 - c. Drill anticipated 10" diameter, **0.365" thick wall minimum, 40.48 lbs/ft steel casing with drive shoe to hard rock, then 10" open hole to 300 ft. deep non-potable well. Field iron test kit shall be used during drilling to determine water well iron content which may determine shorter depth. Coordinate water testing with Owners testing agency.** ~~with potable type casing so in the future it could be reclassified as a potable well and used as such.~~ It is anticipated that this will be an artisan well, as the other two large wells on site are. **Install a spill pipe welded to side of casing to connect to 6" outfall pipe.**
 - d. Install new 50 HP, 400 GPM class stainless steel pump **and motor**, PVC drop pipe and wire in well below pitless adapter, and access pipe to pull pitless adapter for future maintenance.
 - e. Excavate and install a ~~Mass 10J4~~ **Baker 10x6 or comparable** weld on **spool type** pitless adapter.
 - f. Install up to 25 ft. of 6" HDPE underground pipe at a depth of 6 ft. with tracer wire and pipe size adapters, as needed **from pitless adapter to site contractors 6" pipe from hydrant.**
 - g. ~~Furnish and install 6 ft. bury fire hydrant with needed blocking.~~ **This work is under separate contract.**
 - h. Back-fill trench and finish grade disturbed areas. **Machine only, no hand work.**
 - i. Install up to ~~250~~ **140** ft. of 6" **SDR35 pipe with 90 degree L and short pipe up**, graded outfall pipe to the west for the artisan over spill, to run to area near the fire water storage pond that serves the main campus building fire protection system. **Install stainless steel screen and collar at outfall end.**
 - j. Test new pump, hydrant, and instruct school personnel.
 - k. All disturbed areas shall be finished graded. Reseeding by owner.
 - l. Electrical work by owner.
- B. Work shall be complete, including appurtenances, all as described. Mobilization, temporary utilities, portable toilets, construction debris removal, labor, materials, products, equipment, transportation, services and the like shall be provided in quantities to complete the Project. Singular specifications shall be considered plural where they apply.
- C. O & M Manuals: Deliver to Owner all Operation and Maintenance manuals, bound in three ring binder and in PDF format.

Page Intentionally Left Blank

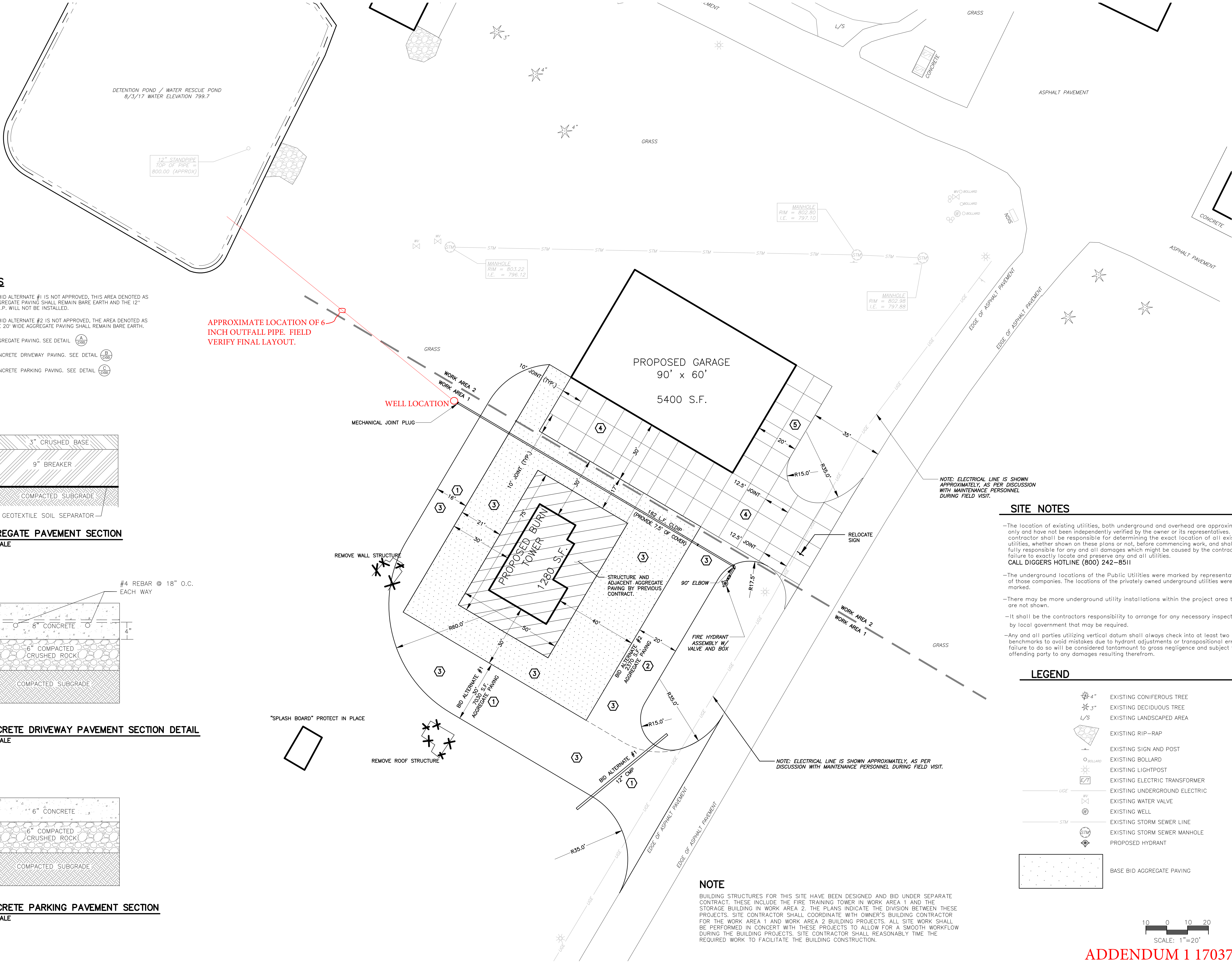

NOTES

- IF BID ALTERNATE #1 IS NOT APPROVED, THIS AREA DENOTED AS AGGREGATE PAVING SHALL REMAIN BARE EARTH AND THE 12" C.M.P. WILL NOT BE INSTALLED.
- IF BID ALTERNATE #2 IS NOT APPROVED, THE AREA DENOTED AS THE 20' WIDE AGGREGATE PAVING SHALL REMAIN BARE EARTH.
- AGGREGATE PAVING. SEE DETAIL
- CONCRETE DRIVEWAY PAVING. SEE DETAIL
- CONCRETE PARKING PAVING. SEE DETAIL

APPROXIMATE LOCATION OF 6 INCH OUTFALL PIPE. FIELD VERIFY FINAL LAYOUT.

SITE NOTES

- The location of existing utilities, both underground and overhead are approximate only and have not been independently verified by the owner or its representatives. The contractor shall be responsible for determining the exact location of all existing utilities, whether shown on these plans or not, before commencing work, and shall be fully responsible for any and all damages which might be caused by the contractor's failure to exactly locate and preserve any and all utilities.
- The underground locations of the Public Utilities were marked by representatives of those companies. The locations of the privately owned underground utilities were not marked.
- There may be more underground utility installations within the project area that are not shown.
- It shall be the contractors responsibility to arrange for any necessary inspections by local government that may be required.
- Any and all parties utilizing vertical datum shall always check into at least two (2) benchmarks to avoid mistakes due to hydrant adjustments or transpositional errors. Failure to do so will be considered tantamount to gross negligence and subject the offending party to any damages resulting therefrom.

LEGEND

- EXISTING CONIFEROUS TREE
- EXISTING DECIDUOUS TREE
- EXISTING LANDSCAPED AREA
- EXISTING RIP-RAP
- EXISTING SIGN AND POST
- EXISTING BOLLARD
- EXISTING LIGHTPOST
- EXISTING ELECTRIC TRANSFORMER
- EXISTING UNDERGROUND ELECTRIC
- EXISTING WATER VALVE
- EXISTING WELL
- EXISTING STORM SEWER LINE
- EXISTING STORM SEWER MANHOLE
- PROPOSED HYDRANT
- BASE BID AGGREGATE PAVING

NOTE

BUILDING STRUCTURES FOR THIS SITE HAVE BEEN DESIGNED AND BID UNDER SEPARATE CONTRACT. THESE INCLUDE THE FIRE TRAINING TOWER IN WORK AREA 1 AND THE STORAGE BUILDING IN WORK AREA 2. THE PLANS INDICATE THE DIVISION BETWEEN THESE PROJECTS. SITE CONTRACTOR SHALL COORDINATE WITH OWNER'S BUILDING CONTRACTOR FOR THE WORK AREA 1 AND WORK AREA 2 BUILDING PROJECTS. ALL SITE WORK SHALL BE PERFORMED IN CONCERT WITH THESE PROJECTS TO ALLOW FOR A SMOOTH WORKFLOW DURING THE BUILDING PROJECTS. SITE CONTRACTOR SHALL REASONABLY TIME THE REQUIRED WORK TO FACILITATE THE BUILDING CONSTRUCTION.

ADDENDUM 1 17037-3

REVISIONS	BY
9-21-17	RCJ

PARAGON ASSOCIATES
Environmental Design & Consulting
CIVIL ENGINEERING · LANDSCAPE ARCHITECTURE · SURVEYING
632 COPELAND AVENUE · LA CROSSE, WI 54603
Tel: 608.781.3110 Fax: 608.781.3197 Paragon-Associ.biz

PREPARED FOR:
WESTERN TECHNICAL
COLLEGE

WESTERN TECHNICAL COLLEGE - SPARTA CAMPUS SITE
WORK AND STORAGE BUILDING FLOOR - FIRE TRAINING AREA
1177 COUNTY ROAD A
SPARTA, WI 54656
SITE PLAN, UTILITIES & DEMO

DRAWN R.C.J.
PROJECT No 17-023
DATE 9/21/2017
SCALE 1"=20'
CAD FILE 17-023 WTC Sparta Fire Training_revised 9-20-17
SHEET

C100